

**TEVAC SHOULDER LEADER PINS**  
1/2 & 17/32

1/2" Part No.	D	G	C	17/32" Part No.
LPSH-050-1	7/8	7/8	1-3/4	LPSH-053-1
LPSH-050-2		1-3/8	2-1/4	LPSH-053-2
LPSH-050-3		1-7/8	2-3/4	LPSH-053-3
LPSH-050-4		2-3/8	3-1/4	LPSH-053-4
LPSH-050-5	1-3/8	7/8	2-1/4	LPSH-053-5
LPSH-050-6		1-3/8	2-3/4	LPSH-053-6
LPSH-050-7		1-7/8	3-1/4	LPSH-053-7
LPSH-050-8	1-7/8	7/8	2-3/4	LPSH-053-8
LPSH-050-9		1-3/8	3-1/4	LPSH-053-9
LPSH-050-10		1-7/8	3-3/4	LPSH-053-10
LPSH-050-11	2-3/8	7/8	3-1/4	LPSH-053-11
LPSH-050-12	2-7/8	1-3/8	4-1/4	LPSH-053-12

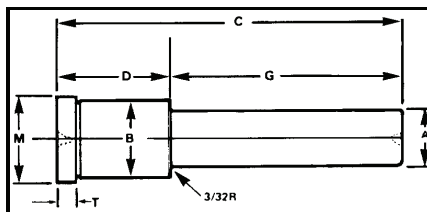

GENERAL DIMENSIONS AND TOLERANCES				
Nominal Size	A	B	M	T
1/2"	.499	.751	.853	3/16
17/32"	.530	.751	.853	3/16
	+ .0000 - .0000	+ .0005 - .0000	(MAX)	

**SHOULDER**

1/2" Part No.	C	17/32" Part No.
BSH-050-1	7/8	BSH-053-1
BSH-050-2	1-3/8	BSH-053-2
BSH-050-3	1-7/8	BSH-053-3
BSH-050-4	2-3/8	BSH-053-4

**GENERAL DIMENSIONS & TOLERANCES**

Nominal Size	A	B	M	T
1/2"	.500	.7505	.853	3/16
17/32"	.531	.7505	.853	3/16
	+ .0005 - .0000	+ .0005 - .0000	(MAX)	

**TEVAC BUSHINGS**  
1/2 & 17/32



**STRAIGHT**

1/2" Part No.	C	17/32" Part No.
BS-050-1	7/8	BS-053-1
BS-050-2	1-3/8	BS-053-2

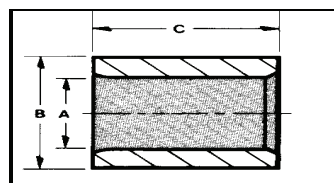
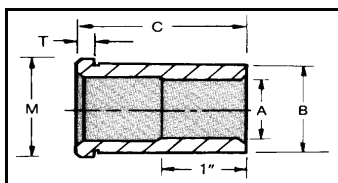

D DIA.	C HEIGHT	PART NUMBER
1"	2.5	TH-1025
	3.0	TH-1030
	3.5	TH-1035
	4.0	TH-1040
	4.5	TH-1045
1.25"	2.5	TH-1225
	3.0	TH-1230
	3.5	TH-1235
	4.0	TH-1240
	4.5	TH-1245
	5.0	TH-1250
1.5"	2.5	TH-1525
	3.0	TH-1530
	3.5	TH-1535
	4.0	TH-1540
	4.5	TH-1545
	5.0	TH-1550
	6.0	TH-1560

D DIA.	C HEIGHT	PART NUMBER
1.75"	2.5	TH-1725
	3.0	TH-1730
	3.5	TH-1735
	4.0	TH-1740
	4.5	TH-1745
2"	5.0	TH-1750
	6.0	TH-1760
	2.5	TH-2025
	3.0	TH-2030
	3.5	TH-2035
	4.0	TH-2040
2.5"	4.5	TH-2045
	5.0	TH-2050
	6.0	TH-2060
	3.0	TH-2530
	3.5	TH-2535
	4.0	TH-2540
	4.5	TH-2545
	5.0	TH-2550
	6.0	TH-2560

**TEVAC SUPPORT PILLARS**  
INDUSTRY STANDARD TAPPED HOLE

D DIA.	C HEIGHT	PART NUMBER
3"	3.0	TH-3030
	3.5	TH-3035
	4.0	TH-3040
	4.5	TH-3045
	5.0	TH-3050
3"	6.0	TH-3060
	8.0	TH-3080

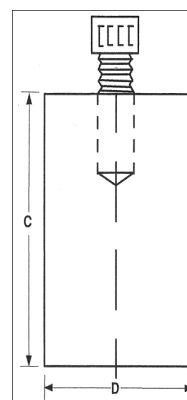

- Constructed from the Highest quality SAE 1040 Steel.
- Precision ground heights are flat and parallel.
  - Tapped hole.
- SHCS included at **no charge**
  - up to 2" diameter requires 3/8-16 screw.
  - 2" and up requires 5/8-11 screw

**Note: Doweled & Drilled & Counterbored Styles also available. Call for pricing.**

**SPECIALS MADE UPON REQUEST !**

**TEVAC OFFERS THIN SHOULDER LEADER PINS  
AND MATCHING THIN WALL BUSHINGS**

**ID=3/4" BUSHINGS**

Others #	Tevac #	L
H15A	<b>BSHT-4-3/4</b>	2-3/8
H16A	<b>BSHT-5-3/4</b>	2-7/8
H17A	<b>BSHT-6-3/4</b>	3-3/8
H18A	<b>BSHT-7-3/4</b>	3-7/8
H19A	<b>BSHT-8-3/4</b>	4-3/8

**ID=1" BUSHINGS**

Others #	Tevac #	L
H15C	<b>BSHT-4-1</b>	2-3/8
H16C	<b>BSHT-5-1</b>	2-7/8
H17C	<b>BSHT-6-1</b>	3-3/8
H18C	<b>BSHT-7-1</b>	3-7/8
H11C	<b>BSHT-10-1</b>	5-7/8

Nom. ID	A	B	M	T
<b>3/4"</b>	.7505	1.001	1.125	.187
<b>1"</b>	1.001	1.251	1.375	.250
Tolerances	+ .000	+ .0005	+ .000	+ .0000
	- .0005	- .0000	- .010	- .005

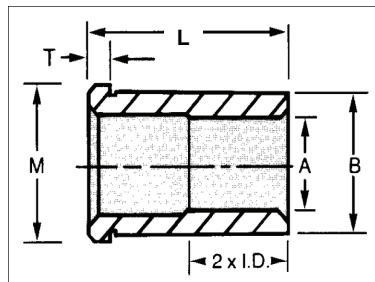

**3/4" SHOULDER LEADER PINS**

Others #	Tevac #	D	G	L
F4A041	<b>LPSHT-187-4-3/4</b>	1-7/8	2-1/4	4-1/8
F4A055	<b>LPSHT-187-7-3/4</b>	1-7/8	3-3/4	5-5/8
F5A041	<b>LPSHT-237-2-3/4</b>	2-3/8	1-3/4	4-1/8
F5A045	<b>LPSHT-237-3-3/4</b>	2-3/8	2-1/4	4-5/8
F5A051	<b>LPSHT-237-4-3/4</b>	2-3/8	2-3/4	5-1/8
F5A065	<b>LPSHT-237-7-3/4</b>	2-3/8	4-1/4	6-5/8
F6A051	<b>LPSHT-287-3-3/4</b>	2-7/8	2-1/4	5-1/8
F6A055	<b>LPSHT-287-4-3/4</b>	2-7/8	2-3/4	5-5/8
F7A055	<b>LPSHT-337-2-3/4</b>	3-3/8	2-1/4	5-5/8
F7A061	<b>LPSHT-337-3-3/4</b>	3-3/8	2-3/4	6-1/8
F8A061	<b>LPSHT-387-2-3/4</b>	3-7/8	2-1/4	6-1/8

**1" SHOULDER LEADER PINS A=1"**

Others #	Tevac #	D	G	L
F5C045	<b>LPSHT-237-3-1</b>	2-3/8	2-1/4	4-5/8
F5C051	<b>LPSHT-237-4-1</b>	2-3/8	2-3/4	5-1/8
F6C051	<b>LPSHT-287-3-1</b>	2-7/8	2-1/4	5-1/8
F6C055	<b>LPSHT-287-4-1</b>	2-7/8	2-3/4	5-5/8
F6C075	<b>LPSHT-287-8-1</b>	2-7/8	4-3/4	7 5/8

Nom. ID	A	B	M	T
<b>3/4"</b>	.749	1.001	1.125	.187
<b>1"</b>	.999	1.251	1.375	.250
Tolerances	+ .0000	+ .00055	+ .000	+ .000
	- .0005	- .0000	- .010	- .005

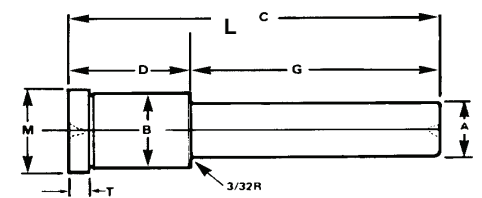

**GENERAL DIMENSIONS**

Nom. ID	A	B	M	T
3/4	.7505	1.1255	1.250	3/16
7/8	.8755	1.2505	1.375	3/16
1"	1.0005	1.3755	1.500	3/16
1-1/4	1.2505	1.6255	1.750	3/16
1-1/2	1.5005	2.0005	2.125	3/16
2"	2.0005	2.5005	2.625	3/16
2-1/2	2.5005	3.2505	3.375	3/16

For Correct product, order by Part Number and insert "A" diameter where (dia) appears.  
**Example: For a 2-7/8" long Shoulder Bushing with a 2-1/2" diameter, BSH-5-212**

Part Number	C
<b>BSH-1-(dia)</b>	7/8
<b>BSH-2-(dia)</b>	1-3/8
<b>BSH-3-(dia)</b>	1-7/8
<b>BSH-4-(dia)</b>	2-3/8
<b>BSH-5-(dia)</b>	2-7/8
<b>BSH-6-(dia)</b>	3-3/8
<b>BSH-7-(dia)</b>	3-7/8
<b>BSH-8-(dia)</b>	4-3/8
<b>BSH-9-(dia)</b>	4-7/8
<b>BSH-10-(dia)</b>	5-7/8

TOLERANCES	
INSIDE DIAMETER (A)	+ .0005 - .0000
OUTSIDE DIAMETER (B)	+ .0005 - .0000
HEAD DIAMETER (M)	+ .000 - .010
HEAD THICKNESS (T)	+ .000 - .005

**Note:**  
Solid Aluminum Bronze and Self-Lubricating also available.  
Call for pricing.

**TEVAC SHOULDER BUSHINGS  
STEEL HARDENED AND PRECISION GROUND**

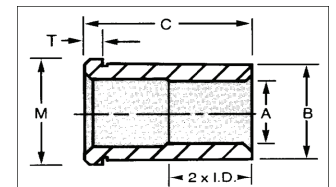

**DIAMETERS**

- A = 3/4"
- A = 7/8"
- A = 1"
- A = 1-1/4"
- A = 1-1/2"
- A = 2"
- A = 2-1/2"

**TEVAC  
STRAIGHT BUSHINGS  
HARDENED AND PRECISION GROUND**

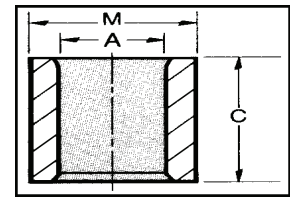

**Note:**  
Solid Aluminum Bronze and  
Self-Lubricating also available.  
Call for pricing.

PART NO.	NOM. ID	A +.0005 -.0000	C	M +.0005 -.0000
BS-1	3/4	.7505	7/8	1.1255
BS-2	3/4	.7505	1-3/8	1.1255
BS-3	7/8	.8755	1-3/8	1.2505
BS-4	1"	1.0005	1-3/8	1.3755
BS-5	1-1/4	1.2505	1-3/8	1.6255
BS-6	1-1/4	1.2505	1-7/8	1.6255
BS-7	1-1/2	1.5005	1-3/8	2.0005
BS-8	1-1/2	1.5005	1-7/8	2.0005
BS-9	2"	2.0005	3-7/8	2.5005
BS-10	2-1/2	2.5005	4-7/8	3.2505

TOLERANCES	
INSIDE DIAMETER (A)	+.0005 -.0000
OUTSIDE DIAMETER (B)	+.0005 -.0000
HEAD DIAMETER (M)	+.000 -.010
HEAD THICKNESS (T)	+.000 -.005

TEVAC'S Guided Ejector Bushings are designed to hold the ejector assembly aligned and prevent potential cocking of ejector plates. It is recommended that a minimum of four bushings be used. Steel, solid aluminumized bronze, and self-lubricating bushings will reduce wear on ejection components.

**TEVAC  
GUIDED EJECTOR BUSHING  
SELF LUBRICATING, STEEL,  
SOLID ALUMINIZED BRONZE**

**SELF-LUBRICATING**

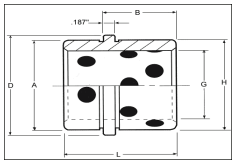

PART NO.	NOM. I.D.	A	D	B	G	H	L
GEB-075SL	3/4	1.1240	1.302	1.00	.751	1.1255	1.50
GEB-087SL	7/8	1.2490	1.427	1.00	.876	1.2505	1.50
GEB-100SL	1"	1.3740	1.557	1.12	1.001	1.3755	1.75
GEB-125SL	1-1/4	1.6240	1.802	1.12	1.251	1.6255	1.75
GEB-150SL	1-1/2	1.9990	2.177	1.12	1.501	2.0005	1.75
GEB-200SL	2"	2.4990	2.687	1.62	2.001	2.5005	2.25

TOLERANCES				
A	D	G	H	L
+.000 -.0001	(MAX.)	+.0005 -.0000	+.0005 -.0000	+.00 -.03

**STEEL**

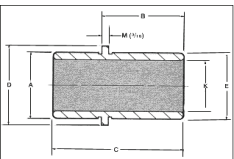

PART NO.	NOM. I.D.	K	E	A	D	C	B
GEB-075	3/4	.751	1.1255	1.1240	1.302	1.50	1.00
GEB-087	7/8	.876	1.2505	1.2490	1.427	1.50	1.00
GEB-100	1"	1.001	1.3755	1.3740	1.552	1.75	1.12
GEB-125	1-1/4	1.251	1.6255	1.6240	1.802	1.75	1.12
GEB-150	1-1/2	1.501	2.0005	1.9990	2.177	1.75	1.12

TOLERANCES						
A	B	C	D	E	K	M
+.000 -.001	+.000 -.030	+.00 -.03	(MAX.)	+.0005 -.0000	+.0005 -.0000	+.005 -.005

**SOLID ALUMINUM BRONZE**

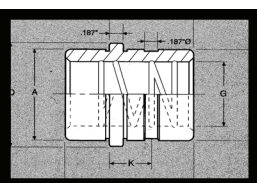

PART NO.	NOM. I.D.	G	H	A	D	L	B	K
GEB-075A	3/4	.751	1.1255	1.1240	1.302	1.50	1.00	.56
GEB-087A	7/8	.876	1.2505	1.2490	1.427	1.50	1.00	.56
GEB-100A	1"	1.001	1.3755	1.3740	1.557	1.75	1.12	.62
GEB-125A	1-1/4	1.251	1.6255	1.6240	1.802	1.75	1.12	.62
GEB-150A	1-1/2	1.501	2.0005	1.9990	2.177	1.75	1.12	.62
GEB-200A	2"	2.001	2.5005	2.4990	2.687	2.25	1.62	.80

TOLERANCES				
G	H	A	D	L
+.0005 -.0000	+.0005 -.0000	+.000 -.001	(MAX)	+.00 -.03